

100TiG20 Assembly.

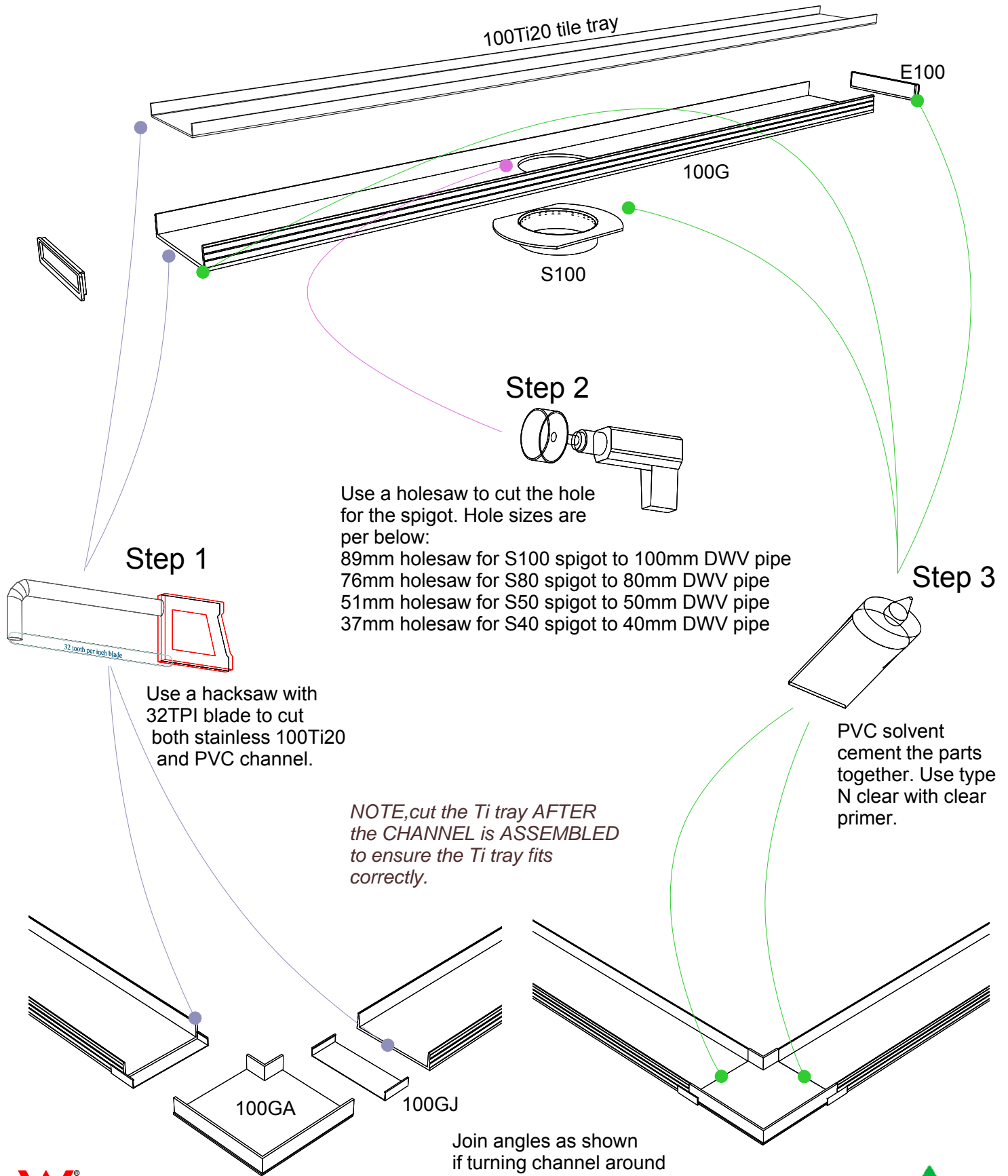

NOTE, longest length of Ti tray 1200mm.
longest run possible 2.0m



Step 1

Use a hacksaw with 32TPI blade to cut both stainless 100Ti20 and PVC channel.

Step 2

Use a holesaw to cut the hole for the spigot. Hole sizes are per below:
89mm holesaw for S100 spigot to 100mm DWV pipe
76mm holesaw for S80 spigot to 80mm DWV pipe
51mm holesaw for S50 spigot to 50mm DWV pipe
37mm holesaw for S40 spigot to 40mm DWV pipe

Step 3

PVC solvent cement the parts together. Use type N clear with clear primer.

NOTE, cut the Ti tray AFTER the CHANNEL is ASSEMBLED to ensure the Ti tray fits correctly.

Join angles as shown if turning channel around a 90 degree corner.

